



## Blank end insert tool

737/10

Art.No. 58270010  
GTIN 4018754034598  
Model 737/10

### Label.

Blank end insert tool Dimensions 8 x 14 Tool holders 9 x 12 L.8mm

### Features.

- gunmetal finish
- to prevent damage from excessive temperatures, the locking pin, spring and washer are not fitted until the welding work has been completed
- instructions are supplied
- material: 1.2208 - 31CRV3

## Advantages.

Gun metal finish.

## Technical Drawing.

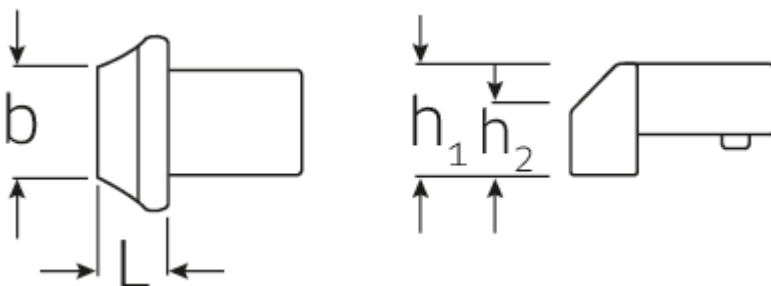

## Technical Attributes.

Welding dimensions hxw in mm 8 x 14

## Logistics data.

Depth mm (IFS) 71

Size square socket [inside square drive]	9 x 12 mm	Width mm (IFS)	27
Height mm (h1)	14,5 mm	Height mm (IFS)	16
Height mm (h2)	8 mm	Length (packed, mm)	120
Length mm (L)	8 mm	Width (packed, mm)	40
		Height (packed, mm)	20
		Volume (packed, dm3)	0.096 dm3
		Art. no.	58270010
		Weight (gross, kg)	0,035
		Weight PAP (kg)	0,000
		Weight PVC (kg)	0,003
		GTIN	4018754034598
		Country of origin	GERMANY
		Region of origin	Nordrhein-Westfalen
		WEEE/ElektroG	nicht ear-pflichtig
		Customs tariff no.	82041100
		Packing standard	1
		Weight	35 g

## Variants.

Art. no.	Art. no. (ERP)	Description	GTIN
58270010	737/10	Blank end insert Tool holders Dimensions 8 x 14 9 x 12 L.8mm	4018754034598

## GTIN-Code.



### STAHLWILLE Eduard Wille GmbH & Co. KG

Lindenallee 27 · 42349 Wuppertal · Germany · Phone: +49 202 4791-0 · Fax: +49 202 4791-200  
 info@stahlwille.de · www.stahlwille.com · Copyright by STAHLWILLE Eduard Wille GmbH & Co. KG, Wuppertal  
 Copyright by STAHLWILLE Eduard Wille GmbH & Co. KG, Wuppertal