



Blank end insert tool

737/40

Art.No. **58270040**
GTIN **4018754034604**
Model **737/40**

Label.

Blank end insert tool Dimensions 11 x 25 Tool holders 14 x 18 L.12mm

Features.

- gunmetal finish
- to prevent damage from excessive temperatures, the locking pin, spring and washer are not fitted until the welding work has been completed
- instructions are supplied
- material: 1.2208 - 31CRV3

Advantages.

Gun metal finish.

Technical Drawing.

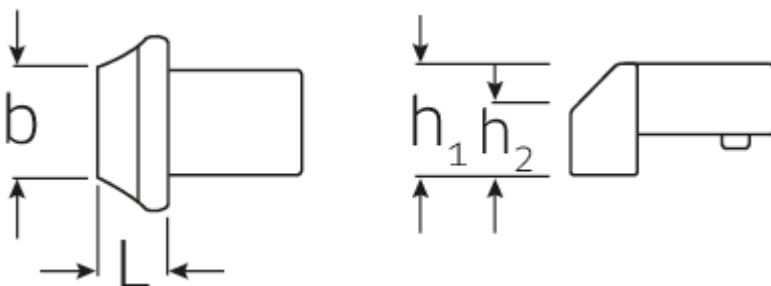

Technical Attributes.

Welding dimensions hxw in mm 11 x 25

Logistics data.

Depth mm (IFS)

72

Size square socket [inside square drive]	14 x 18 mm	Width mm (IFS)	33
Height mm (h1)	21,5 mm	Height mm (IFS)	23
Height mm (h2)	11 mm	Length (packed, mm)	73
Length mm (L)	12 mm	Width (packed, mm)	34
		Height (packed, mm)	24
		Volume (packed, dm3)	0.059568 dm3
		Art. no.	58270040
		Weight (gross, kg)	0,100
		Weight PAP (kg)	0,000
		Weight PVC (kg)	0,003
		GTIN	4018754034604
		Country of origin	GERMANY
		Region of origin	Nordrhein-Westfalen
		WEEE/ElektroG	nicht ear-pflichtig
		Customs tariff no.	82041100
		Packing standard	1
		Weight	98 g

Variants.

Art. no.	Art. no. (ERP)	Description	GTIN
58270040	737/40	Blank end insert tool Dimensions 11 x 25 Tool holders 14 x 18 L.12mm	4018754034604

GTIN-Code.



STAHLWILLE Eduard Wille GmbH & Co. KG

Lindenallee 27 · 42349 Wuppertal · Germany · Phone: +49 202 4791-0 · Fax: +49 202 4791-200
 info@stahlwille.de · www.stahlwille.com · Copyright by STAHLWILLE Eduard Wille GmbH & Co. KG, Wuppertal
 Copyright by STAHLWILLE Eduard Wille GmbH & Co. KG, Wuppertal