



Blank end insert tool

737/100

Art.No. **58270100**
GTIN **4018754239740**
Model **737/100**

Label.

Blank end insert tool Dimensions 15 x 50 Tool holders 22 x 28 L.24mm

Features.

- gunmetal finish
- to prevent damage from excessive temperatures, the locking pin, spring and washer are not fitted until the welding work has been completed
- instructions are supplied
- material: 1.2208 - 31CRV3

Advantages.

Gun metal finish.

Technical Drawing.

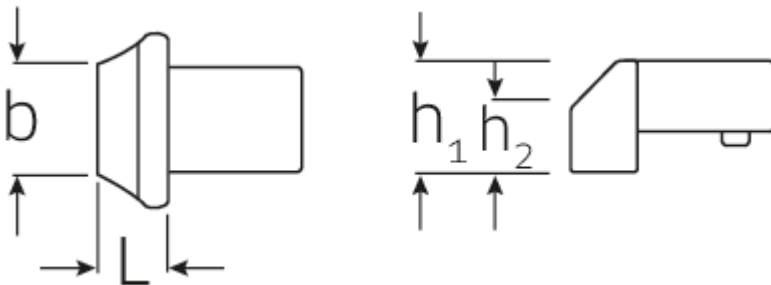

Technical Attributes.

Welding dimensions h x w in mm 15 x 50

Logistics data.

Depth mm (IFS) 65

Size square socket [inside square drive]	22 x 28 mm	Width mm (IFS)	60
Height mm (h1)	32 mm	Height mm (IFS)	33
Height mm (h2)	15 mm	Length (packed, mm)	105
Length mm (L)	24 mm	Width (packed, mm)	60
		Height (packed, mm)	35
		Volume (packed, dm ³)	0.2205 dm ³
		Art. no.	58270100
		Weight (gross, kg)	0,490
		Weight PAP (kg)	0,000
		Weight PVC (kg)	0,004
		GTIN	4018754239740
		Country of origin	GERMANY
		Region of origin	Nordrhein-Westfalen
		WEEE/ElektroG	nicht ear-pflichtig
		Customs tariff no.	82041100
		Packing standard	1
		Weight	483 g

Variants.

Art. no.	Art. no. (ERP)	Description	GTIN
58270100	737/100	Blank end insert tool Dimensions 15 x 50 Tool holders 22 x 28 L.24mm	4018754239740

GTIN-Code.



STAHLWILLE Eduard Wille GmbH & Co. KG

Lindenallee 27 · 42349 Wuppertal · Germany · Phone: +49 202 4791-0 · Fax: +49 202 4791-200
 info@stahlwille.de · www.stahlwille.com · Copyright by STAHLWILLE Eduard Wille GmbH & Co. KG, Wuppertal
 Copyright by STAHLWILLE Eduard Wille GmbH & Co. KG, Wuppertal