

QuickRelease fine-tooth flexible-joint ratchet

416QR



Art.No. 11261010
GTIN 4018754286362
Model 416QR



Label.

QR fine-tooth jointed ratchet 1/4 RSW.4.5° L.170mm

Features.

- Switchable
- 80 teeth
- with QuickRelease safety lock
- with 2-component handle
- handle lever up and down approx. 90° swivelling, engaging and locking in the following positions:
 - straight
 - 30° upwards
 - 60° upwards
 - 30° downwards
- Releasing the lock by push button in the handle area
- for working in confined spaces, with working angle of only 4, 5°
- FOD-preventive due to screwless design
- simple release of the lock by push button in the handle area
- made of high-quality Chrome-Alloy-Steel
- DIN 3122/ISO 3315 - DBGM (German Federal Utility Model)

Advantages.

STAHLWILLE 1/4" reversible articulated ratchet with QR push button release.

Patented QuickRelease locking system secures every component from ratchet to joint to socket without wasting space.

The high-quality chrome-alloy-steel finish promises a long service life.

80 teeth allow a practical working angle of only 4.5 ° - for even power transmission and precise use in tight spaces.

Ratchet head swivels 90°, lockable in 4 positions (0°; 30°/60° up; 30° down) - for hard-to-reach screw connections.

Product highlights.



Ideal for continuous use.

The ratchet is made from high-quality forged chrome alloy steel and is also chrome plated, giving it excellent robustness and durability, even in continuous use. It is designed for precise and reliable continuous use in passenger or commercial vehicle workshops, assembly and industry.

Technologies and features.



QuickRelease

The QuickRelease technology ensures tools cannot be inadvertently lost – while enabling rapid, safe tool changes.



Foreign Object Damage

STAHLWILLE protects against foreign object damage. The preferred choice in safety-relevant fields such as aerospace, thanks to the screwless design.



Fine tooth ratchet mechanisms.

STAHLWILLE fine tooth ratchets have a specially developed, perfectly balanced mechanism with 80 teeth, ensuring maximum load capacity and, at the same time, excellent durability. With STAHLWILLE fine-tooth ratchets, no less than eight teeth engage at once, which provides smooth working action. The tight ratchet angle of only 4.5° enables efficient working in confined spaces.



2-component handle

Our 2-component handle is non-slip and has an ergonomic shape. It is resistant to oils, grease, fuels, brake fluids and Skydrol.

Technical Attributes.

a	12 mm
External square drive (inch)	1/4
Number of teeth	80
Working angle	4.5 °
Width mm (b)	22,5 mm
Length mm (L)	170 mm

Logistics data.

Depth mm (IFS)	170
Width mm (IFS)	20
Height mm (IFS)	20
Length (packed, mm)	220
Width (packed, mm)	30
Height (packed, mm)	25

No.	416QR	Volume (packed, dm3)	0.165 dm3
		Art. no.	11261010
		Weight (gross, kg)	0,130
		Weight PAP (kg)	0,000
		Weight PVC (kg)	0,004
		GTIN	4018754286362
		Country of origin	GERMANY
		Region of origin	Nordrhein-Westfalen
		WEEE/ElektroG	nicht ear-pflichtig
		Customs tariff no.	82042000
		Packing standard	1
		Weight	170 g

Variants.

Art. no.	Art. no. (ERP)	Description	GTIN
11261010	416QR	QR fine-tooth jointed ratchet 1/4 RSW.4.5° L.170mm	4018754286362

GTIN-Code.



Accessories.



11180010
Bit holder



11030003
Adapter

Images.

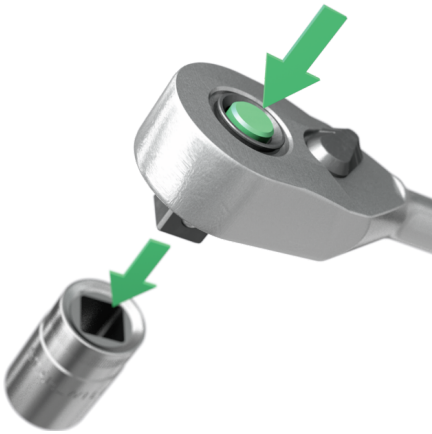

STAHLWILLE Eduard Wille GmbH & Co. KG

Lindenallee 27 · 42349 Wuppertal · Germany · Phone: +49 202 4791-0 · Fax: +49 202 4791-200
info@stahlwille.de · www.stahlwille.com · Copyright by STAHLWILLE Eduard Wille GmbH & Co. KG, Wuppertal
Copyright by STAHLWILLE Eduard Wille GmbH & Co. KG, Wuppertal