

## QuickRelease fine-tooth flexible-joint ratchet

452QR



Art.No. 12261010  
GTIN 4018754286379  
Model 452QR



### Label.

QR fine-tooth jointed ratchet 3/8 RSW.4.5° L.300mm

### Features.

- Reversible
- 80 teeth
- With QuickRelease security lock
- With 2-component handle
- Handle levers can be swivelled up and down by approximately 90°, engages and locks in the following positions:
  - straight
  - 30° upward
  - 60° upward
  - 30° downward
- Release lock with push button in handle area
- For work in confined spaces, with a working angle of only 4.5°
- FOD-preventive due to screw-less design
- DIN 3122/ISO 3315
- DBGM

## Advantages.

### Interchangeable

Unique QR locking system – secures every component from ratchet to extension to socket without wasting space

## Technologies and features.



### QuickRelease

The QuickRelease technology ensures tools cannot be inadvertently lost – while enabling rapid, safe tool changes.



### Foreign Object Damage

STAHLWILLE protects against foreign object damage. The preferred choice in safety-relevant fields such as aerospace, thanks to the screwless design.



### Fine tooth ratchet mechanisms.

STAHLWILLE fine tooth ratchets have a specially developed, perfectly balanced mechanism with 80 teeth, ensuring maximum load capacity and, at the same time, excellent durability. With STAHLWILLE fine-tooth ratchets, no less than eight teeth engage at once, which provides smooth working action. The tight ratchet angle of only 4.5° enables efficient working in confined spaces.

## Technical Attributes.

a	14,5 mm
External square drive (inch)	3/8
Number of teeth	80
Working angle	4.5 °
Width mm (b)	28,2 mm
Length mm (L)	300 mm

## Logistics data.

Depth mm (IFS)	300
Width mm (IFS)	30
Height mm (IFS)	30
Length (packed, mm)	350
Width (packed, mm)	35
Height (packed, mm)	35
Volume (packed, dm3)	0.42875 dm3
Art. no.	12261010
Weight (gross, kg)	0,366
Weight PAP (kg)	0,000
Weight PVC (kg)	0,007
GTIN	4018754286379
Country of origin	GERMANY
Region of origin	Nordrhein-Westfalen
WEEE/ElektroG	nicht ear-pflichtig
Customs tariff no.	82042000
Packing standard	1
Weight	350 g

## Variants.

Art. no.	Art. no. (ERP)	Description	GTIN
12261010	452QR	QR fine-tooth jointed ratchet 3/8 RSW.4.5° L.300mm	4018754286379

## GTIN-Code.



## Accessories.



02501024  
CROW-FOOT spanner  
heavy-duty inch



02501028  
CROW-FOOT spanner  
heavy-duty inch



02501032  
CROW-FOOT spanner  
heavy-duty inch



02501034  
CROW-FOOT spanner  
heavy-duty inch



02501036  
CROW-FOOT spanner  
heavy-duty inch



02501038  
CROW-FOOT spanner  
heavy-duty inch



02501040  
CROW-FOOT spanner  
heavy-duty inch



02501042  
CROW-FOOT spanner  
heavy-duty inch



12180026  
Bit holder



02501044  
CROW-FOOT spanner  
heavy-duty inch



02501046  
CROW-FOOT spanner  
heavy-duty inch



12180030  
Bit holder



02501048  
CROW-FOOT spanner  
heavy-duty inch



02501050  
CROW-FOOT spanner  
heavy-duty inch



02501052  
CROW-FOOT spanner  
heavy-duty inch



02501054  
CROW-FOOT spanner  
heavy-duty inch



02501056  
CROW-FOOT spanner  
heavy-duty inch



02501058  
CROW-FOOT spanner  
heavy-duty inch



02501060  
CROW-FOOT spanner  
heavy-duty inch



02501062  
CROW-FOOT spanner  
heavy-duty inch



12030001  
Adapter



12030003  
Adapter

## Images.

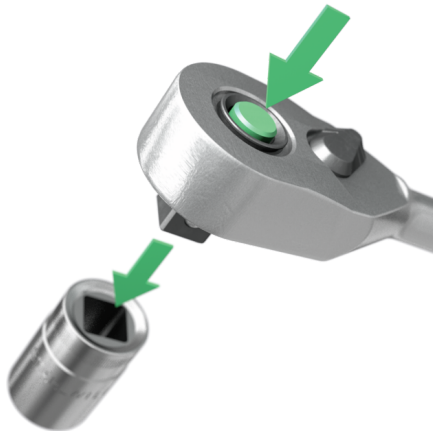

**STAHLWILLE Eduard Wille GmbH & Co. KG**

Lindenallee 27 · 42349 Wuppertal · Germany · Phone: +49 202 4791-0 · Fax: +49 202 4791-200  
info@stahlwille.de · www.stahlwille.com · Copyright by STAHLWILLE Eduard Wille GmbH & Co. KG, Wuppertal  
Copyright by STAHLWILLE Eduard Wille GmbH & Co. KG, Wuppertal