

QuickRelease ratchet, fine tooth

435QR N



Art.No. 12111020
GTIN 4018754235919
Model 435QR N



Label.

QR fine-tooth ratchet 3/8 RSW.4.5° L.193mm

Features.

- Reversible
- 80 teeth
- With QuickRelease security lock
- With 2-component handle
- For work in confined spaces, with a working angle of only 4.5°
- FOD-preventive due to screw-less design
- DIN 3122/ISO 3315
- DBGM

Advantages.

Interchangeable

Unique QR locking system – secures every component from ratchet to extension to socket without wasting space



Technologies and features.



QuickRelease

The QuickRelease technology ensures tools cannot be inadvertently lost – while enabling rapid, safe tool changes.



Foreign Object Damage

STAHLWILLE protects against foreign object damage. The preferred choice in safety-relevant fields such as aerospace, thanks to the screwless design.



Fine tooth ratchet mechanisms.

STAHLWILLE fine tooth ratchets have a specially developed, perfectly balanced mechanism with 80 teeth, ensuring maximum load capacity and, at the same time, excellent durability. With STAHLWILLE fine-tooth ratchets, no less than eight teeth engage at once, which provides smooth working action. The tight ratchet angle of only 4.5° enables efficient working in confined spaces.

Technical Attributes.

a	15 mm
External square drive (inch)	3/8
Number of teeth	80
Working angle	4.5 °
Width mm (b)	30 mm
DIN	DIN 3122/ISO 3316
Length mm (L)	193 mm

Logistics data.

Depth mm (IFS)	195
Width mm (IFS)	31
Height mm (IFS)	15
Length (packed, mm)	197
Width (packed, mm)	31
Height (packed, mm)	25
Volume (packed, dm ³)	0.152675 dm ³
Art. no.	12111020
Weight (gross, kg)	0,245
Weight PAP (kg)	0,000
Weight PVC (kg)	0,005
GTIN	4018754235919
Country of origin	GERMANY
Region of origin	Nordrhein-Westfalen
WEEE/ElektroG	nicht ear-pflichtig
Customs tariff no.	82042000
Packing standard	1
Weight	235 g

Variants.

Art. no.	Art. no. (ERP)	Description	GTIN
12111020	435QR N	QR fine-tooth ratchet 3/8 RSW.4.5° L.193mm	4018754235919

GTIN-Code.



Accessories.



02501024
CROW-FOOT spanner
heavy-duty inch



02501028
CROW-FOOT spanner
heavy-duty inch



02501032
CROW-FOOT spanner
heavy-duty inch



02501034
CROW-FOOT spanner
heavy-duty inch



02501036
CROW-FOOT spanner
heavy-duty inch



02501038
CROW-FOOT spanner
heavy-duty inch



02501040
CROW-FOOT spanner
heavy-duty inch



02501042
CROW-FOOT spanner
heavy-duty inch



02501044
CROW-FOOT spanner
heavy-duty inch



12180026
Bit holder



02501046
CROW-FOOT spanner
heavy-duty inch



12180030
Bit holder



02501048
CROW-FOOT spanner
heavy-duty inch



02501050
CROW-FOOT spanner
heavy-duty inch



02501052
CROW-FOOT spanner
heavy-duty inch



02501054
CROW-FOOT spanner
heavy-duty inch



02501056
CROW-FOOT spanner
heavy-duty inch



02501058
CROW-FOOT spanner
heavy-duty inch



02501060
CROW-FOOT spanner
heavy-duty inch



02501062
CROW-FOOT spanner
heavy-duty inch

Spare parts/spare part for.



19021020
Spare parts set for
ratchet No.435QR N

Images.

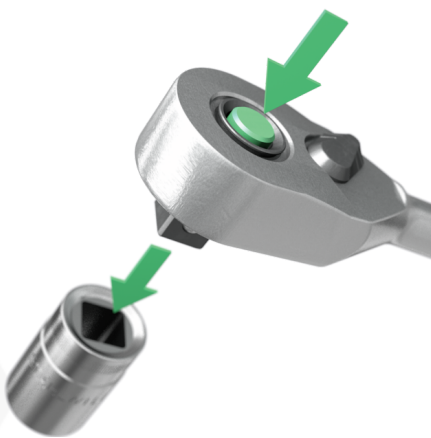



STAHLWILLE Eduard Wille GmbH & Co. KG

Lindenallee 27 · 42349 Wuppertal · Germany · Phone: +49 202 4791-0 · Fax: +49 202 4791-200
info@stahlwille.de · www.stahlwille.com · Copyright by STAHLWILLE Eduard Wille GmbH & Co. KG, Wuppertal
Copyright by STAHLWILLE Eduard Wille GmbH & Co. KG, Wuppertal