

## QuickRelease ratchet, fine tooth

### 435SG-QR N



Art.No. 12111030  
GTIN 4018754284313  
Model 435SG-QRN



#### Label.

QuickRelease ratchet, fine tooth 3/8 RSW.4.5° L.193mm

#### Features.

- Reversible
- 80 teeth
- With QuickRelease security lock
- With steel handle
- For work in confined spaces, with a working angle of only 4.5°
- FOD-preventive due to screw-less design
- DIN 3122/ISO 3315
- DGBM

## Advantages.

#### Interchangeable

Unique QR locking system – secures every component from ratchet to extension to socket without wasting space

## Technologies and features.



#### QuickRelease

The QuickRelease technology ensures tools cannot be inadvertently lost – while enabling rapid, safe tool changes.



### Foreign Object Damage

STAHLWILLE protects against foreign object damage. The preferred choice in safety-relevant fields such as aerospace, thanks to the screwless design.



### Fine tooth ratchet mechanisms.

STAHLWILLE fine tooth ratchets have a specially developed, perfectly balanced mechanism with 80 teeth, ensuring maximum load capacity and, at the same time, excellent durability. With STAHLWILLE fine-tooth ratchets, no less than eight teeth engage at once, which provides smooth working action. The tight ratchet angle of only 4.5° enables efficient working in confined spaces.

## Technical Attributes.

a	15 mm
External square drive (inch)	3/8
Number of teeth	80
Working angle	4.5 °
Width mm (b)	30 mm
DIN	DIN 3122/ISO 3316
Length mm (L)	193 mm

## Logistics data.

Depth mm (IFS)	190
Width mm (IFS)	30
Height mm (IFS)	27
Length (packed, mm)	190
Width (packed, mm)	30
Height (packed, mm)	27
Volume (packed, dm <sup>3</sup> )	0.1539 dm <sup>3</sup>
Art. no.	12111030
Weight (gross, kg)	0,272
Weight PAP (kg)	0,000
Weight PVC (kg)	0,006
GTIN	4018754284313
Country of origin	GERMANY
Region of origin	Nordrhein-Westfalen
WEEE/ElektroG	nicht ear-pflichtig
Customs tariff no.	82042000
Packing standard	1
Weight	272 g

## Variants.

Art. no.	Art. no. (ERP)	Description	GTIN
12111030	435SG-QRN	QuickRelease ratchet, fine tooth 3/8 RSW.4.5° L.193mm	4018754284313

## GTIN-Code.



## Accessories.



02501024  
CROW-FOOT spanner  
heavy-duty inch



12030001  
Adapter



12030003  
Adapter



02501028  
CROW-FOOT spanner  
heavy-duty inch



02501032  
CROW-FOOT spanner  
heavy-duty inch



02501034  
CROW-FOOT spanner  
heavy-duty inch



02501036  
CROW-FOOT spanner  
heavy-duty inch



02501038  
CROW-FOOT spanner  
heavy-duty inch



02501040  
CROW-FOOT spanner  
heavy-duty inch



02501042  
CROW-FOOT spanner  
heavy-duty inch



02501044  
CROW-FOOT spanner  
heavy-duty inch



12180026  
Bit holder



02501046  
CROW-FOOT spanner  
heavy-duty inch



12180030  
Bit holder



02501048  
CROW-FOOT spanner  
heavy-duty inch



02501050  
CROW-FOOT spanner  
heavy-duty inch



02501052  
CROW-FOOT spanner  
heavy-duty inch



02501054  
CROW-FOOT spanner  
heavy-duty inch



02501056  
CROW-FOOT spanner  
heavy-duty inch



02501058  
CROW-FOOT spanner  
heavy-duty inch



02501060  
CROW-FOOT spanner  
heavy-duty inch



02501062  
CROW-FOOT spanner  
heavy-duty inch

## Spare parts/spare part for.



19021020  
Spare parts set for  
ratchet No.435QR N

## Images.

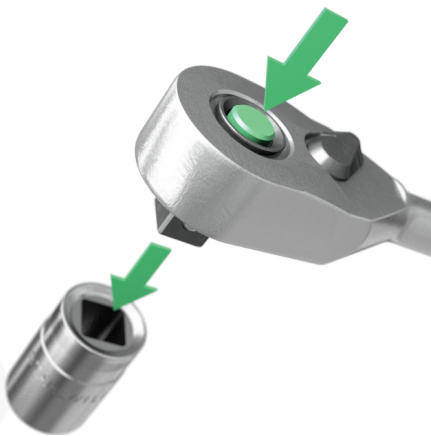



**STAHLWILLE Eduard Wille GmbH & Co. KG**

Lindenallee 27 · 42349 Wuppertal · Germany · Phone: +49 202 4791-0 · Fax: +49 202 4791-200  
info@stahlwille.de · www.stahlwille.com · Copyright by STAHLWILLE Eduard Wille GmbH & Co. KG, Wuppertal  
Copyright by STAHLWILLE Eduard Wille GmbH & Co. KG, Wuppertal