



## QR fine tooth ratchet set, 1/4"+1/2"

415QR/512QR



Art.No. 91336421

GTIN 4018754342914

Model 415QR/512QR Knarrensatz



### Label.

QR fine tooth ratchet set 2 pcs.

### Features.

- QuickRelease ratchet set with 1/4" and 1/2" drives
- With QuickRelease safety lock, secure fit and easy release of socket wrenches and connecting parts
- To work in confined spaces, with a working angle of only 4.5°
- FOD-preventive due to screw-less design
- Made of high-quality chrome alloy steel
- 2-component handles made of impact-resistant, Skydrol-resistant plastic
- Easy-to-use switch lever for left/right rotation
- DIN 3122/ISO 3315
- DBGM

#### Contents 2-piece set:

1 QR fine tooth ratchet 1/4" no. 415QR: L. 117 mm

1 QR fine tooth ratchet 1/2" no. 512QR: L. 265.5 mm

## Advantages.

Made in Germany – interchangeable STAHLWILLE ratchet with 2-component handle, 80 sprockets, QR push button release, DIN 3122/ISO 3315, chrome alloy steel, chrome-plated

Patented QuickRelease locking system – secures every component from ratchet to extension to socket

80 sprockets allow for a working angle of only 4.5° – facilitating efficient working even in confined spaces

STAHLWILLE: For over 160 years, we as a traditional German company from Wuppertal have stood for tools that are appreciated around the world for their excellent quality

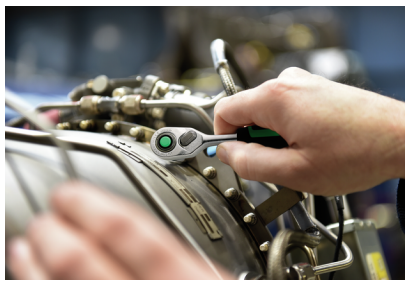

## Product highlights.



### **FAST.**

QuickRelease enables rapid tool changes and secures them reliably during work operations.

## Technologies and features.



### **QuickRelease**

The QuickRelease technology ensures tools cannot be inadvertently lost – while enabling rapid, safe tool changes.



### **Foreign Object Damage**

STAHLWILLE protects against foreign object damage. The preferred choice in safety-relevant fields such as aerospace, thanks to the screwless design.



### **Fine tooth ratchet mechanisms.**

STAHLWILLE fine tooth ratchets have a specially developed, perfectly balanced mechanism with 80 teeth, ensuring maximum load capacity and, at the same time, excellent durability. With STAHLWILLE fine-tooth ratchets, no less than eight teeth engage at once, which provides smooth working action. The tight ratchet angle of only 4.5° enables efficient working in confined spaces.



### **RESILIENT.**

High Performance Quality (HPQ®) High-performance steel – extremely resilient, yet thin-walled and ideal for working in confined spaces.

## Technical Attributes.

Number of tools	2 pcs.
Width mm (b)	90 mm
Height mm (h)	40 mm
Length mm (L)	310 mm

## Logistics data.

Length (IFS)	310
Width (IFS)	90
Height (IFS)	40
Length (packed, mm)	310
Width (packed, mm)	90
Height (packed, mm)	40
Volume (packed, mm)	1.116 dm <sup>3</sup>
Code	91336421
Weight (gross, kg)	0,808
Weight PAP (kg)	0,030
Weight PVC (kg)	0,010
GTIN	4018754342914
Country of origin	GERMANY
Region of origin	Nordrhein-Westfalen
WEEE/Electrical Act	nicht ear-pflichtig
Customs tariff no.	82042000
Numbers of content units per order units	1
Weight	808 g

## Parts list.



13111120  
QuickRelease ratchet,  
fine tooth

11111020  
QR fine-tooth ratchet

## Variants.

Code	Article number (ERP)	Article description (Autom.)	GTIN
91336421	415QR/512QR Knarrensatz	QR fine tooth ratchet set 2 pcs.	4018754342914

## GTIN-Code.



## Spare parts.



19012020  
Spare parts set for  
ratchet No.415QR N,  
415QRL N, 415SG-QR  
N, 416QR, 418QR



19040040  
Spare parts set for  
ratchet No.512QR N

## Images.

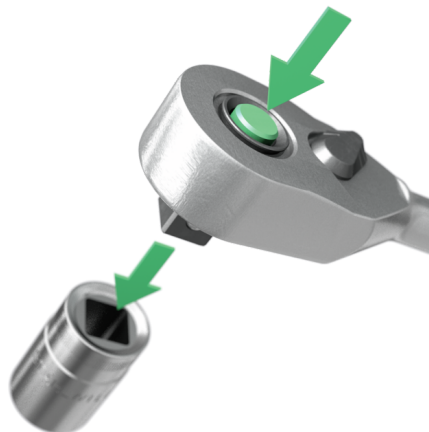



**STAHLWILLE Eduard Wille GmbH & Co. KG**

Lindenallee 27 · 42349 Wuppertal · Germany · Phone: +49 202 4791-0 · Fax: +49 202 4791-200  
info@stahlwille.de · www.stahlwille.de · Copyright by STAHLWILLE Eduard Wille GmbH & Co. KG, Wuppertal  
Copyright by STAHLWILLE Eduard Wille GmbH & Co. KG, Wuppertal