

**POWER**

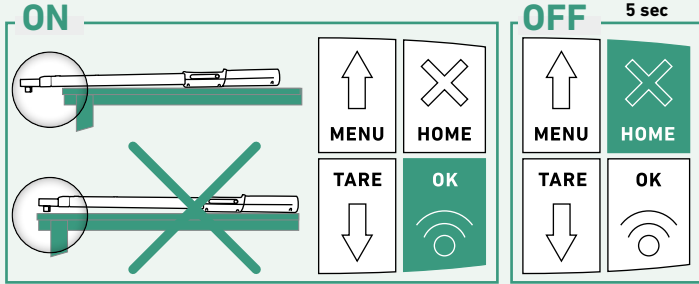

**DISPLAY**

**N·m  
in·lb  
ft·lb**

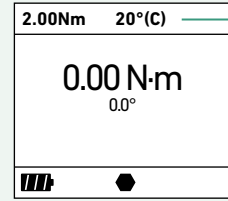

**(C)lick  
(T)rack  
(P)eak hold**

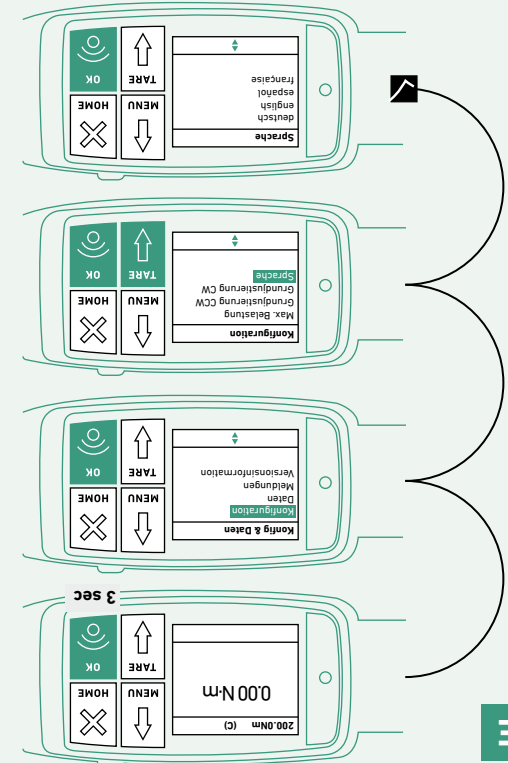

DE Sprache  
EN Language  
ES Idioma  
FR Langue  
IT Lingua

**LANGUAGE**

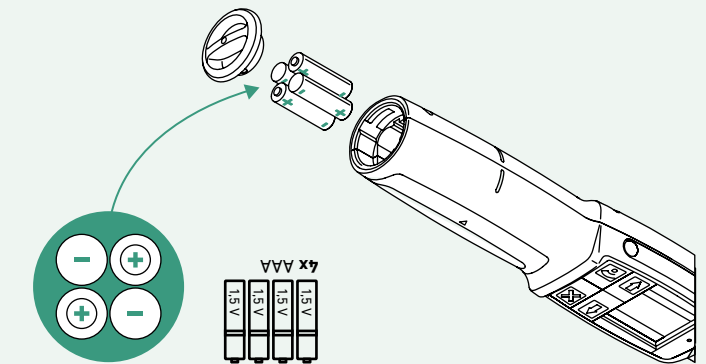
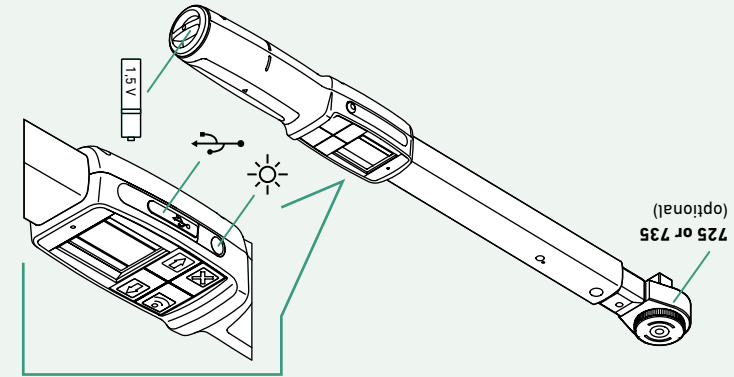

© STAHLWILLE Eduard Wille GmbH & Co. KG // 2,5-02-23 DHF // V 2.0 // 91979816  
 STAHLWILLE Eduard Wille GmbH & Co. KG · Lindentallee 27 · 42349 Wuppertal · Germany  
 Tél: +49 202 4791-0 · Fax: +49 202 4791-200 · info@stahlwille.de · www.stahlwille.com

**TOOLS**  
that inspire

**MANOSKOP® 714**  
Short instructions



**STAHLWILLE®**

MADE IN CRONENBERG  
MADE IN GERMANY

- !** DE Verpackungsinhalt  
EN Contents  
ES Contenido del embalaje  
FR Contenu du packaging  
IT Contenuto della confezione



www.stahlwille.com/  
en\_de/products/  
detail/852564

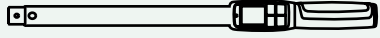

1x



1x



4x AAA

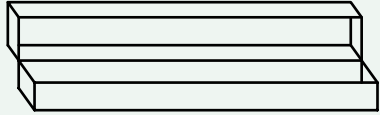

1x



1x



3x

- 4** EN Setup Menu > Nm  
ES Entrada Directa > Nm  
FR Menu Direct > Nm  
IT Impostazione diretta > Nm

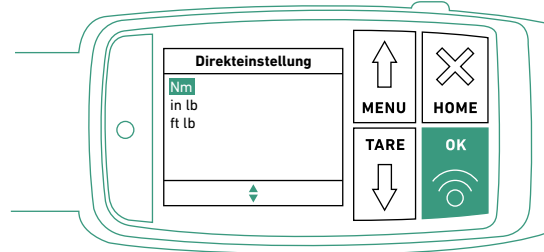

- 8** EN Setup Menu > Click  
ES Entrada Directa > Disparo  
FR Menu Direct > Déclenchement  
IT Impostazione diretta > Scatto

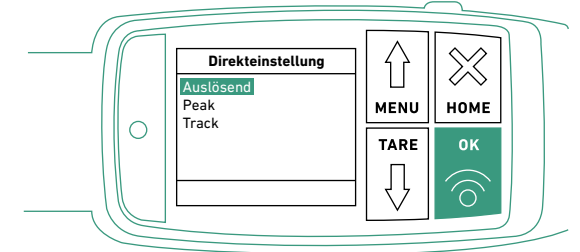

- 1** DE Praxisbeispiel  
EN Practical example  
ES Ejemplo práctico  
FR Exemple pratique  
IT Esempio pratico

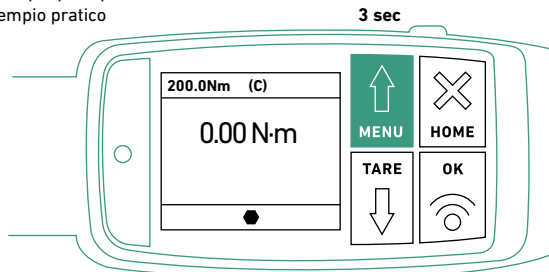

- 5** EN Setup Menu > Torque  
ES Entrada Directa > Par de apriete  
FR Menu Direct > Couple  
IT Impostazione diretta > Coppia

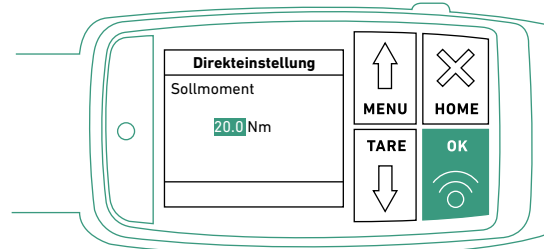

- 9** EN Setup Menu > Extension Length  
ES Entrada Directa > Cota del util  
FR Menu Direct > Longueur embout  
IT Impostazione diretta > Misura di estensione

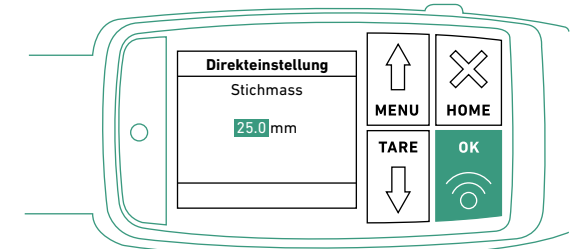

- 2** EN Main Menu > Direct Input  
ES Menu Principal > Entrada directa  
FR Menu Principal > Mode direct  
IT Menu principale > Metodo diretto

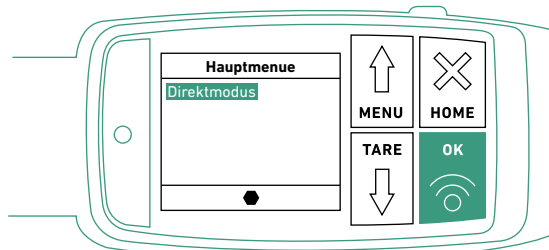

- 6** EN Setup Menu > Rel. Tolerance  
ES Entrada Directa > Tolerancia relativa  
FR Menu Direct > Tolérances rel.  
IT Impostazione diretta > Tolleranza rel.

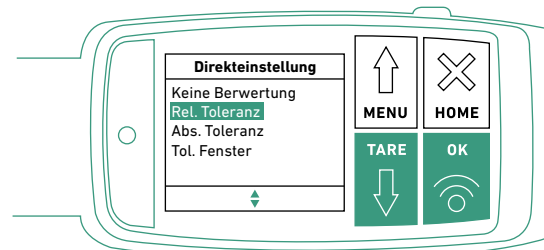

- 10** EN Parameter  
ES Parametro  
FR Paramètres  
IT Parametri

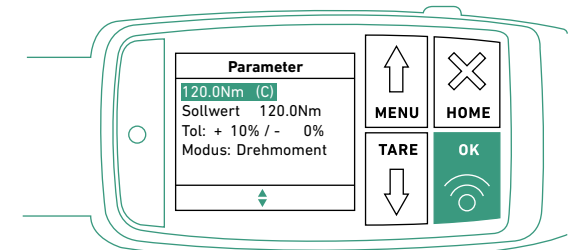

- 3** EN Setup Menu > Torque  
ES Entrada Directa > Par de apriete  
FR Menu Direct > Couple  
IT Impostazione diretta > Coppia

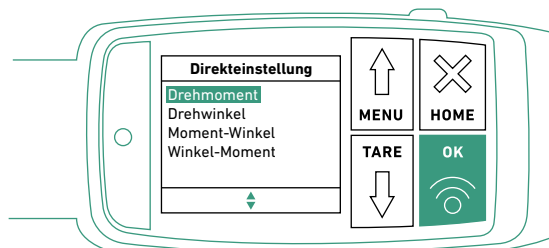

- 7** EN Setup Menu > Torque +Tol 10 % | Torque -Tol 0 %  
ES Entrada Directa > Apriete +Tol 10 % | Apriete -Tol 0 %  
FR Menu Direct > Couple +Tol 10 % | Couple -Tol 0 %  
IT Impostazione diretta > Coppia +Toll... | Coppia -Toll...

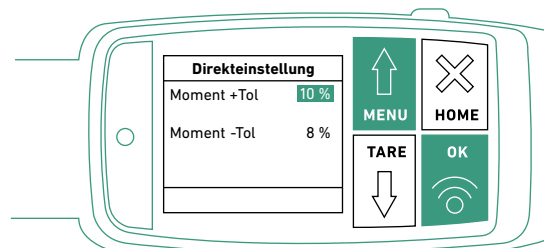

- 11** READY

